

Projects

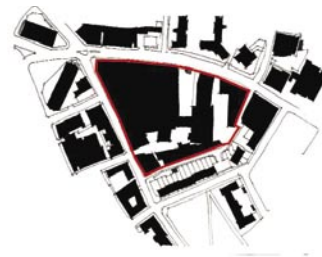

Site as existing

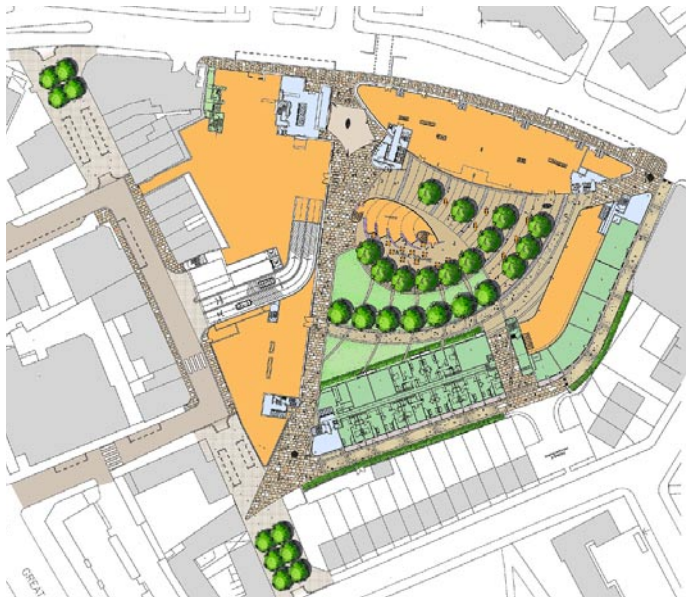

Major axes

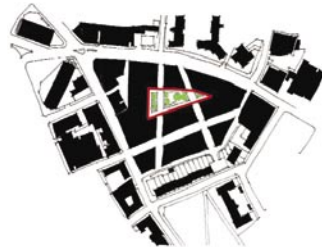

Public gardens



Link to Tabard garden and historical orchard



Site as proposed

Tabard Square London SE1

Client	Berkeley Homes (North East London) Ltd
RSL	Southern Housing Group
Size	572 units (of which 212 are affordable under various tenures: shared ownership; rented; and key worker)
Value	Approximately £75 million
Status	Completed Spring 2007

Tabard Square is an urban regeneration residentially led development. It provides 572 apartments of which 212 are affordable. At its heart it provides London with a new public square accessible to all, with a mix of uses at ground level encouraging city life and vitality. Gym, crèche, supermarket, retail, and office uses surround the square with a sculptural restaurant acting as the central focus. A residential tower in the north west corner of the square is the landmark for the development and a beacon for regeneration for the Borough area.

The quality of the finished development has been recognized through the winning of a number of awards including Housing Design Awards – Overall Winner 2007, and receipt of a CABE Gold Standard Award in 2007. The project was also the winner of the Building Awards – Major Housing Project of the Year 2007.